

How the system works

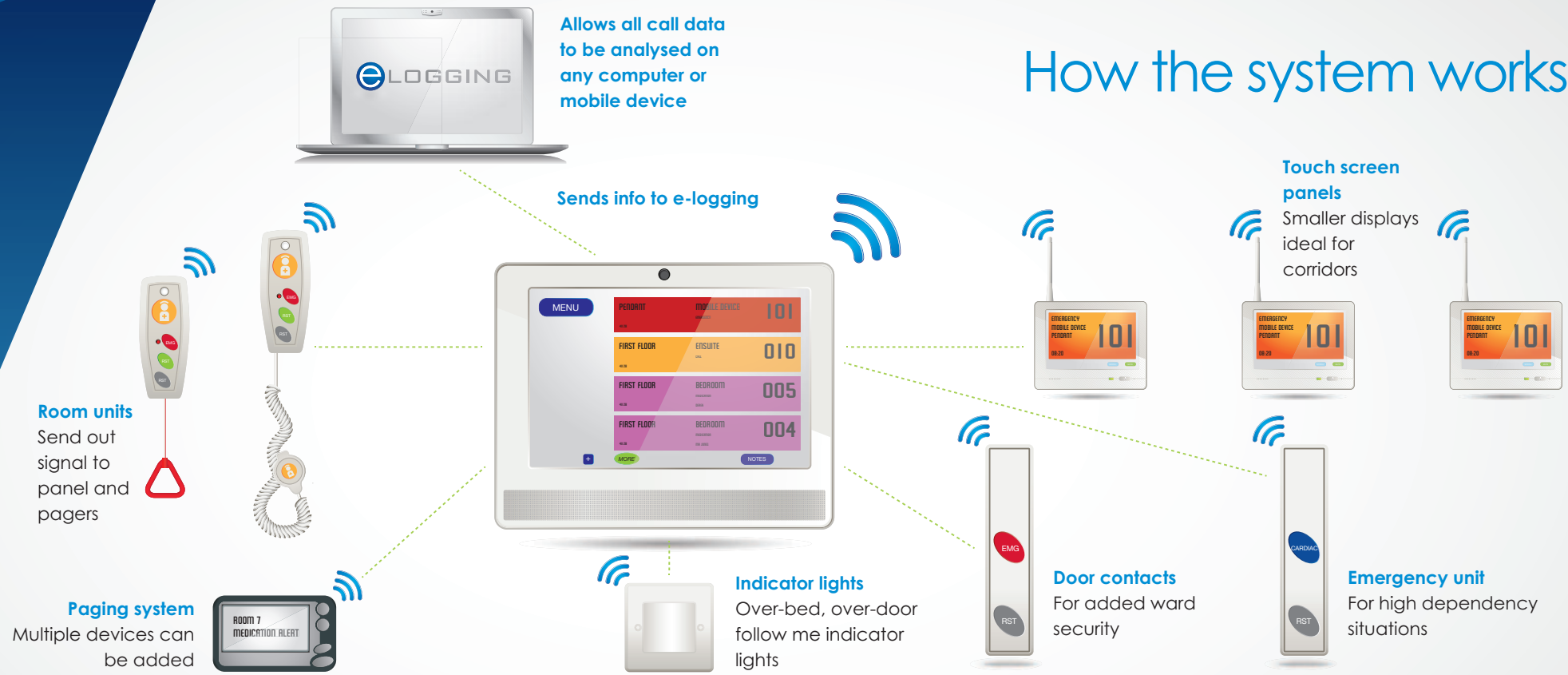

Room Units

Medicare room units are functional, elegant and robust.

Pear Push Lead

This sealed and extendable lead is both ergonomic and practical and comes in a single-button version for patient calls, and a two-button version which operates the resident's bedside light.

Door Contact Units

This neat slimline unit provides door security for internal and external doors.

Indicator Lights

These can be configured for over-bed, over-door or follow me indication. They require a 12V feed with wireless connection to call point.

Emergency Unit

For high dependency situations where an emergency response is vital we supply a specific single blue button unit conforming to HTM specifications.

Paging Systems

Pocket pagers display call information enabling a silent type system.

Accessories

We can supply many accessories that interface with the call system and our own in-house design team have come up with some ingenious devices to allow even the most severely disabled patient to operate the call system.

Accessories include: Pressure pads, bed and chair sensors, PIR detection, enuresis detection, epilepsy monitoring and many more.